



High speed precision spindles

SCHEDA TECNICA

# AF 152 CU HSK E63



MODELLO	TENSIONE [Volt]	FREQUENZA [Hz]	GIRI	POT. RESA Kw	ASSORB. [Amp]	Cos j	PESO [Kg]
AF152 12/4 CU HSK E-63 aria compressa	350	100 - 333	3000 - 10000	6,0	14,2	0,85	59
HSK E-63 liquido	350	100 - 333	3000 - 10000	7,5	17,8	0,85	59
AF152 12/4 CU HSK E-63 aria compressa	350	150 - 333	4500 - 10000	8,0	19,6	0,82	59
HSK E-63 liquido	350	150 - 333	4500 - 10000	9,0	22,1	0,82	59
AF152 12/4 CU HSK E-63 aria compressa	350	200 - 400	6000 - 12000	10,0	23,4	0,82	59
HSK E-63 liquido	350	200 - 400	6000 - 12000	12,0	28,1	0,82	59
AF152 16/4 CU HSK E-63 aria compressa	350	100 - 333	3000 - 10000	7,5	17,8	0,84	75
HSK E-63 liquido	350	100 - 333	3000 - 10000	10,0	23,9	0,84	75
AF152 16/4 CU HSK E-63 aria compressa	350	150 - 333	4500 - 10000	9,0	22,1	0,82	75
HSK E-63 liquido	350	150 - 333	4500 - 10000	12,0	29,4	0,82	75
AF152 16/4 CU HSK E-63 aria compressa	350	200 - 400	6000 - 12000	12,0	28,1	0,80	75
HSK E-63 liquido	350	200 - 400	6000 - 12000	16,0	38,3	0,80	75

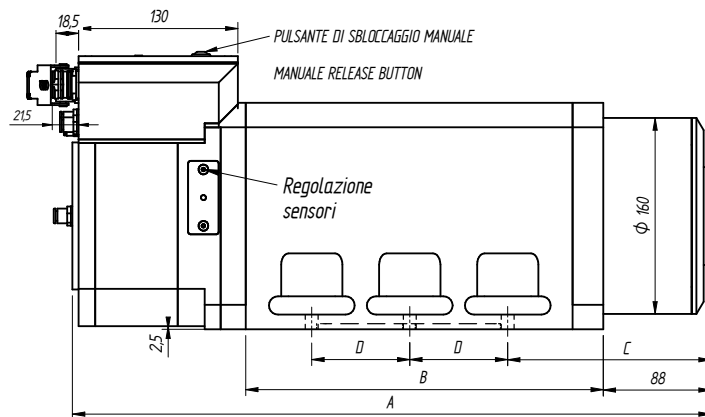
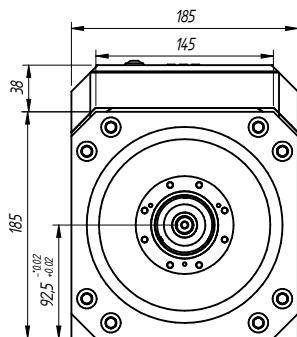

TIPO	Kw	Hz	Volt
AF 152 CU 12/4	7,5	100-333	350
AF 152 CU 12/4	9	150-333	350
AF 152 CU 12/4	12	200-400	350
AF 152 CU 16/4	10-12	100-333	350
AF 152 CU 16/4	12-15	150-333	350
AF 152 CU 16/4	16/18	200-400	350

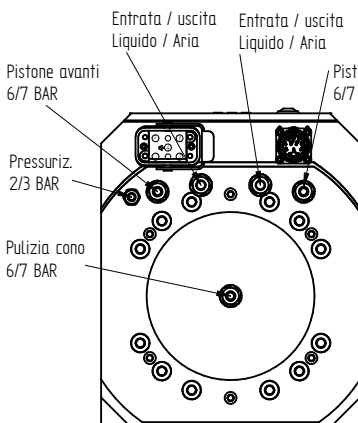
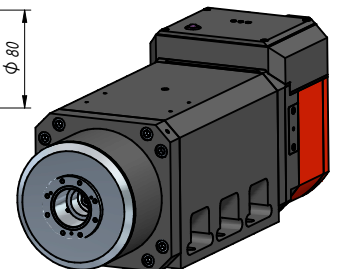

CONNETTORE PER CONTROLLO SENSORI

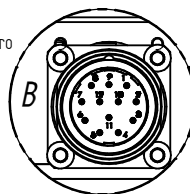

TIPO	A	B	C	D	Codice
AF 152 CU 12/4	481.4	252	126	70	F1L7124 EL006
AF 152 CU 16/4	521.4	292	166	80	F1L7164 CJ001

- 1 - contagiri
- 2 - pistone avanti pinza aperta
- 3 - pistone indietro
- 4 - pistone indietro con utensile agganciato
- 5 - alimentazione sensori + 24 Vdc
- 6 - alimentazione sensori 0 Vdc
- 7 - albero fermo
- 8 - contatto nc protezione termica
- 9 - contatto nc protezione termici



- A 1 - fase motore - U
- 2 - fase motore - V
- 3 - fase motore - W
- 4 - filo di massa - PE

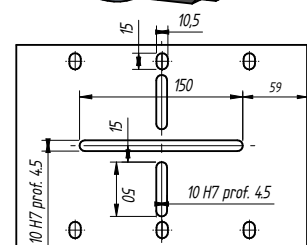

NB. Attacchi aria/liquido e movimentazione pistone da 1/4 gas, pressurizzazione da 1/8 gas

