

ACCESSORIES ZUBEHÖR YEDEKLER



CONTENTS / INHALT / İÇİNDEKİLER

ER-OZ Collet / ER-OZ Spannzange ER-OZ Pens	128
ER Collet with Seal / ER Spannzange mit Abdichtung für IK İçten Su Vermeli ER Pens	132
ER Tap Collet / ER Gewindebohrspannzange ER Kılavuz Pensi	134
Collet for Hydraulic Chuck / Reduzierstück für Hydro-Dehnspannfutter Hidrolik Pensi	136
Collet for Milling Chuck / Spannzange für Kraftspannfutter Pens GKS, Bilyalı Pens Başlığı için	136
Reduction for Coolant Feeder / Reduzierbuchse für Kühlmittelzuführung Redüksiyon, Dıştan Soğ. Takımlar için	137
Clamping Nut OZ-ER/ Spannmutter OZ-ER Kapak OZ-ER	138
Wrench / Hakenschlüssel Ay Anhatar	142
Tapping Collet / Einsatz mit Rutschkupplung Kılavuz Tutucu	144
Shrink Extension / Schrumpferlängerung Shrink Uzatma	146
Collet Chuck with Cylindrical Shank / Spannzangenfutter mit Zylinderschaft Silindirik Şaftlı Pens Başlığı	147
Drill Chuck / Bohrfutter Supra Mandren	148
Pull Stud / Anzugsbolzen Çektirme Civatası	149
3D Edge Sensor / 3D-Kantentaster 3D Saatli Sıfırlama	154
Edge Finder / Kantentaster Elektronik Işıklı & Sesli Prop	155
Fast-mounting Assembly / Schnellmontageblock Üniversal Montaj Aparatı	156
Benchtop Tool Shelf / Tischwerkzeugregal Masaüstü Takım Sehpaları	157



ER Collet DIN 6499

ER Spannzange DIN 6499

ER Pens DIN 6499

Type
ER

Form
B

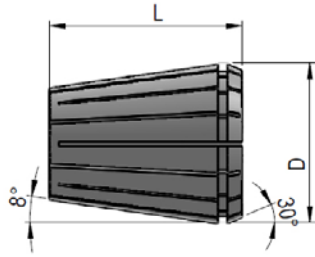

Order No. Bestell-Nr. Sipariş No.	Description Bezeichnung Açıklama Diameters Durchmesser Çaplar	D	L
4004E.Ø	ER8 4004E Ø 1 - 1,5 - 2 - 2,5 - 3 - 3,5 - 4 - 4,5 - 5	8,5	13,6
4008E.Ø	ER11 4008E Ø 1 - 1,5 - 2 - 2,5 - 3 - 3,5 - 4 - 4,5 - 5 - 5,5 - 6 - 6,5 - 7	11,5	18
426E.Ø	ER16 426E Ø 1 - 2 - 3 - 4 - 5 - 6 - 7 - 8 - 9 - 10	17	27,5
428E.Ø	ER20 428E Ø 1 - 2 - 3 - 4 - 5 - 6 - 7 - 8 - 9 - 10 - 11 - 12 - 13	21	31,5
430E.Ø	ER25 430E Ø 1 - 2 - 3 - 4 - 5 - 6 - 7 - 8 - 9 - 10 - 11 - 12 - 13 - 14 15 - 16	26	34
470E.Ø	ER32 470E Ø 1 - 2 - 3 - 4 - 5 - 6 - 7 - 8 - 9 - 10 - 11 - 12 - 13 - 14 15 - 16 - 17 - 18 - 19 - 20	33	40
472E.Ø	ER40 472E Ø 1 - 2 - 3 - 4 - 5 - 6 - 7 - 8 - 9 - 10 - 11 - 12 - 13 - 14 15 - 16 - 17 - 18 - 19 - 20 - 21 - 22 - 23 - 24 - 25 - 26	41	46



Collet Set
Spannzangensatz
Pens Seti

131



OZ Collet DIN 6388

OZ Spannzange DIN 6388

OZ Pens DIN 6388

Type
OZ

Form
B

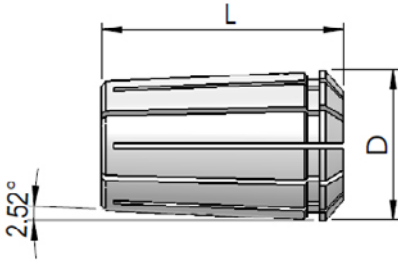

Order No. Bestell-Nr. Sipariş No.	Description Bezeichnung Açıklama Diameters Durchmesser Çaplar	D	L
415E.Ø	OZ16 415E Ø 2 - 3 - 4 - 5 - 6 - 7 - 8 - 9 - 10 - 11 - 12 - 13 - 14 - 15 16	25,5	40
462E.Ø	OZ25 462E Ø 2 - 3 - 4 - 5 - 6 - 7 - 8 - 9 - 10 - 11 - 12 - 13 - 14 - 15 16 - 17 - 18 - 19 - 20 - 21 - 22 - 23 - 24 - 25	35,05	52
467E.Ø	OZ32 467E Ø 2 - 3 - 4 - 5 - 6 - 7 - 8 - 9 - 10 - 11 - 12 - 13 - 14 - 15 16 - 17 - 18 - 19 - 20 - 21 - 22 - 23 - 24 - 25 - 26 - 27 28 - 29 - 30 - 31 - 32	43,7	60



Collet Set
Spannzangensatz
Pens Seti

131



ER UP Collet DIN 6499

Ultra Precision

Type
ER UP

Form
B



ER UP-Spannzange DIN 6499

ER UP Pens DIN 6499

Runout / Rundlauf / Salgi ≤ 0,005 mm

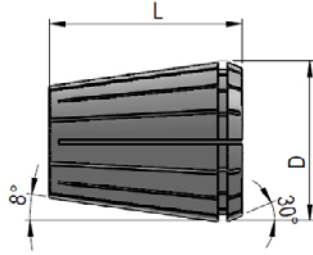

Order No. Bestell-Nr. Sipariş No.	Description Bezeichnung Açıklama Diameters Durchmesser Çaplar	D	L
4004E.Ø.UP	ER8 4004E Ø 1 - 1,5 - 2 - 2,5 - 3 - 3,5 - 4 - 4,5 - 5	8,5	13,6
4008E.Ø.UP	ER11 4008E Ø 1 - 1,5 - 2 - 2,5 - 3 - 3,5 - 4 - 4,5 - 5 - 5,5 - 6 - 6,5 - 7	11,5	18
426E.Ø.UP	ER16 426E Ø 1 - 2 - 3 - 4 - 5 - 6 - 7 - 8 - 9 - 10	17	27,5
428E.Ø.UP	ER20 428E Ø 1 - 2 - 3 - 4 - 5 - 6 - 7 - 8 - 9 - 10 - 11 - 12 - 13	21	31,5
430E.Ø.UP	ER25 430E Ø 1 - 2 - 3 - 4 - 5 - 6 - 7 - 8 - 9 - 10 - 11 - 12 - 13 - 14 15 - 16	26	34
470E.Ø.UP	ER32 470E Ø 1 - 2 - 3 - 4 - 5 - 6 - 7 - 8 - 9 - 10 - 11 - 12 - 13 - 14 15 - 16 - 17 - 18 - 19 - 20	33	40
472E.Ø.UP	ER40 472E Ø 1 - 2 - 3 - 4 - 5 - 6 - 7 - 8 - 9 - 10 - 11 - 12 - 13 - 14 15 - 16 - 17 - 18 - 19 - 20 - 21 - 22 - 23 - 24 - 25 - 26	41	46



Collet Set
Spannzangensatz
Pens Seti

131



Collet Set in Box

Spannzangensatz im Koffer

Pens Takımı, Plastik Kutusu ile



Order No. Bestell-Nr. Sipariş No.	Description Bezeichnung Açıklama	B	L	H
4004E.105	4004E ER8 Ø 1-5 (9 Pcs.)	101	82	40
4008E.107	4008E ER11 Ø 1-7 (13 Pcs.)	101	82	40
426E.110	426E ER16 Ø 1-10 (10 Pcs.)	101	82	40
428E.113	428E ER20 Ø 1-13 (13 Pcs.)	101	82	40
430E.216	430E ER25 Ø 2-16 (15 Pcs.)	235	185	48
470E.320	470E ER32 Ø 3-20 (18 Pcs.)	275	230	83
472E.426	472E ER40 Ø 4-26 (23 Pcs.)	340	270	83
415E.216	415E OZ16 Ø 2-16 (15 Pcs.)	235	185	48
462E.225	462E OZ25 Ø 4-25 (16 Pcs.)	275	230	83
467E.432	467E OZ32 Ø 5-32 (16 Pcs.)	275	230	83

Description / Bezeichnung / Açıklama

4004E	ER8	Ø 1-5	(9 Pcs.)	1-1,5-2-2,5-3-3,5-4-4,5-5
4008E	ER11	Ø 1-7	(13 Pcs.)	1-1,5-2-2,5-3-3,5-4-4,5-5-5,5-6-6,5-7
426E	ER16	Ø 1-10	(10 Pcs.)	1-2-3-4-5-6-7-8-9-10
428E	ER20	Ø 1-13	(13 Pcs.)	1-2-3-4-5-6-7-8-9-10-11-12-13
430E	ER25	Ø 2-16	(15 Pcs.)	2-3-4-5-6-7-8-9-10-11-12-13-14-15-16
470E	ER32	Ø 3-20	(18 Pcs.)	3-4-5-6-7-8-9-10-11-12-13-14-15-16-17-18-19-20
472E	ER40	Ø 4-26	(23 Pcs.)	4-5-6-7-8-9-10-11-12-13-14-15-16-17-18-19-20-21-22-23-24-25-26
415E	OZ16	Ø 2-16	(15 Pcs.)	2-3-4-5-6-7-8-9-10-11-12-13-14-15-16
462E	OZ25	Ø 4-25	(16 Pcs.)	4-5-6-7-8-9-10-11-12-14-16-18-20-22-24-25
467E	OZ32	Ø 5-32	(16 Pcs.)	5-6-8-10-12-14-16-18-20-22-24-25-26-28-30-32

Gisstec®

TOOLING TECHNOLOGY



ER Collet with Seal for Internal Cooling DIN 6499

ER Spannzange mit Abdichtung für IK DIN 6499

İçten Su Vermeli ER Pens DIN 6499

Type
ER

Form
NC



P max.= 70 bar

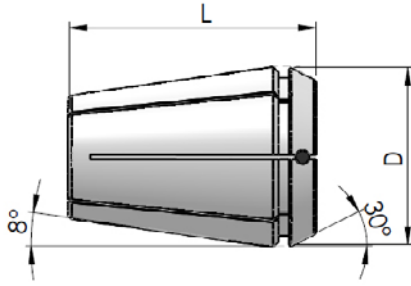

Order No. Bestell-Nr. Sipariş No.	Description Bezeichnung Açıklama Diameters Durchmesser Çaplar	D	L
426E.NC.Ø	ER16 426E Ø 2 - 3 - 4 - 5 - 6 - 7 - 8 - 9 - 10	17	27,5
428E.NC.Ø	ER20 428E Ø 2 - 3 - 4 - 5 - 6 - 7 - 8 - 9 - 10 - 11 - 12 - 13	21	31,5
430E.NC.Ø	ER25 430E Ø 2 - 3 - 4 - 5 - 6 - 7 - 8 - 9 - 10 - 11 - 12 - 13 - 14 15 - 16	26	34
470E.NC.Ø	ER32 470E Ø 3 - 4 - 5 - 6 - 7 - 8 - 9 - 10 - 11 - 12 - 13 - 14 15 - 16 - 17 - 18 - 19 - 20	33	40
472E.NC.Ø	ER40 472E Ø 4 - 5 - 6 - 7 - 8 - 9 - 10 - 11 - 12 - 13 - 14 15 - 16 - 17 - 18 - 19 - 20 - 21 - 22 - 23 - 24 - 25 - 26	41	46

ER Collet for Cooling through Spread Holes DIN 6499

ER Spannzanze mit 4 Schrägbohrungen für Kühlung DIN 6499

Alından Su Vermeli ER Pens DIN 6499

Type
ER

Form
NCD



P max.= 70 bar

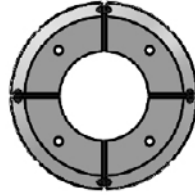
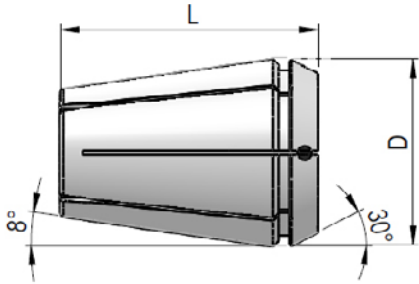

Order No. Bestell-Nr. Sipariş No.	Description Bezeichnung Açıklama Diameters Durchmesser Çaplar	D	L
426E.NCD.Ø	ER16 426E Ø 3 - 4 - 5 - 6 - 7 - 8 - 9 - 10	17	27,5
428E.NCD.Ø	ER20 428E Ø 3 - 4 - 5 - 6 - 7 - 8 - 9 - 10 - 11 - 12 - 13	21	31,5
430E.NCD.Ø	ER25 430E Ø 3 - 4 - 5 - 6 - 7 - 8 - 9 - 10 - 11 - 12 - 13 - 14 15 - 16	26	34
470E.NCD.Ø	ER32 470E Ø 3 - 4 - 5 - 6 - 7 - 8 - 9 - 10 - 11 - 12 - 13 - 14 15 - 16 - 17 - 18 - 19 - 20	33	40
472E.NCD.Ø	ER40 472E Ø 4 - 5 - 6 - 7 - 8 - 9 - 10 - 11 - 12 - 13 - 14 15 - 16 - 17 - 18 - 19 - 20 - 21 - 22 - 23 - 24 - 25 - 26	41	46



ER Tap Collet DIN 6499

ER16 - ER25

Type
ER

Form
G



ER Gewindebohrspannzange DIN 6499

ER Kılavuz Pensi DIN 6499

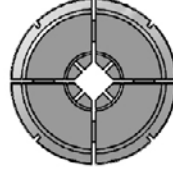
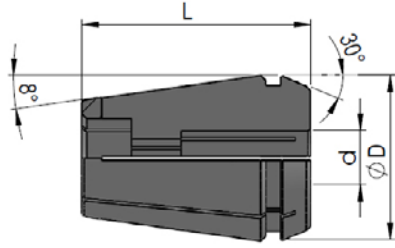

Order No. Bestell-Nr. Sipariş No.	Description Bezeichnung Açıklama	d		D	L
426E.G.3527	ER16 Ø 3,5	3,5	2,7	17	27,5
426E.G.4030	ER16 Ø 4	4	3	17	27,5
426E.G.4534	ER16 Ø 4,5	4,5	3,4	17	27,5
426E.G.649	ER16 Ø 6	6	4,9	17	27,5
426E.G.755	ER16 Ø 7	7	5,5	17	27,5
430E.G.3527	ER25 Ø 3,5	3,5	2,7	26	34
430E.G.4030	ER25 Ø 4	4	3	26	34
430E.G.4534	ER25 Ø 4,5	4,5	3,4	26	34
430E.G.649	ER25 Ø 6	6	4,9	26	34
430E.G.755	ER25 Ø 7	7	5,5	26	34
430E.G.862	ER25 Ø 8	8	6,2	26	34
430E.G.97	ER25 Ø 9	9	7	26	34
430E.G.108	ER25 Ø 10	10	8	26	34
430E.G.119	ER25 Ø 11	11	9	26	34
430E.G.129	ER25 Ø 12	12	9	26	34



ER Gewindebohrspannzange DIN 6499

ER Kılavuz Pensi DIN 6499

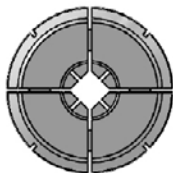
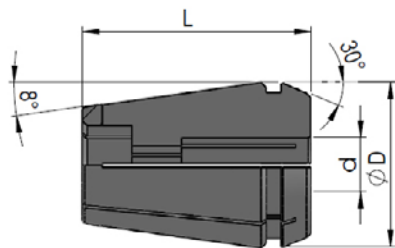

Order No. Bestell-Nr. Sipariş No.	Description Bezeichnung Açıklama	d		D	L
470E.G.4534	ER32 Ø 4,5	4,5	3,4	33	40
470E.G.649	ER32 Ø 6	6	4,9	33	40
470E.G.755	ER32 Ø 7	7	5,5	33	40
470E.G.862	ER32 Ø 8	8	6,2	33	40
470E.G.97	ER32 Ø 9	9	7	33	40
470E.G.108	ER32 Ø 10	10	8	33	40
470E.G.119	ER32 Ø 11	11	9	33	40
470E.G.129	ER32 Ø 12	12	9	33	40
470E.G.1411	ER32 Ø 14	14	11	33	40
470E.G.1612	ER32 Ø 16	16	12	33	40
472E.G.649	ER40 Ø 6	6	4,9	41	46
472E.G.755	ER40 Ø 7	7	5,5	41	46
472E.G.862	ER40 Ø 8	8	6,2	41	46
472E.G.97	ER40 Ø 9	9	7	41	46
472E.G.108	ER40 Ø 10	10	8	41	46
472E.G.119	ER40 Ø 11	11	9	41	46
472E.G.129	ER40 Ø 12	12	9	41	46
472E.G.1411	ER40 Ø 14	14	11	41	46
472E.G.1612	ER40 Ø 16	16	12	41	46
472E.G.18145	ER40 Ø 18	18	14,5	41	46
472E.G.2016	ER40 Ø 20	20	16	41	46

Straight Collet

Reduzierhülse

Silindirik Pens

For Hydraulic and Ultra-Clamp Chuck
Für Hydrodehn- und Ultra-Clamp-Futter
Hidrolik ve Ultra-Clamp Tutucu için

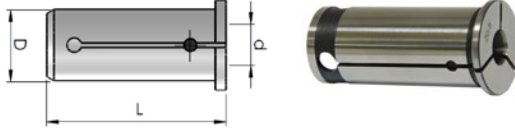

For Milling Chuck
Für Kraftspannfutter
Bilyalı Pens Başlığı için

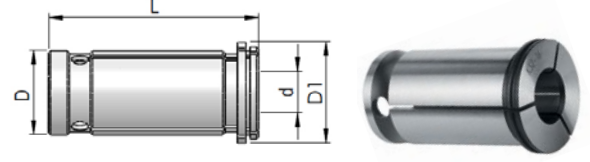

Order No. Bestell-Nr. Sipariş No.	Description Bezeichnung Açıklama	d	D	L
412.30.03	12-06 UP	3	12	44
412.30.04	12-04 UP	4	12	44
412.30.05	12-05 UP	5	12	44
412.30.06	12-06 UP	6	12	44
412.30.08	12-08 UP	8	12	44
420.30.03	20-03 UP	3	20	53
420.30.04	20-04 UP	4	20	53
420.30.05	20-05 UP	5	20	53
420.30.06	20-06 UP	6	20	53
420.30.08	20-08 UP	8	20	53
420.30.10	20-10 UP	10	20	53
420.30.12	20-12 UP	12	20	53
420.30.14	20-14 UP	14	20	53
420.30.16	20-16 UP	16	20	53
432.30.06	32-06 UP	6	32	63
432.30.08	32-08 UP	8	32	63
432.30.10	32-10 UP	10	32	63
432.30.12	32-12 UP	12	32	63
432.30.14	32-14 UP	14	32	63
432.30.16	32-16 UP	16	32	63
432.30.18	32-18 UP	18	32	63
432.30.20	32-20 UP	20	32	63
432.30.25	32-25 UP	25	32	63

Order No. Bestell-Nr. Sipariş No.	Description Bezeichnung Açıklama	d	D	D1	L
420.03.06	20-06 K	6	20	25	50
420.03.08	20-08 K	8	20	25	50
420.03.10	20-10 K	10	20	25	50
420.03.12	20-12 K	12	20	25	50
420.03.16	20-16 K	16	20	25	50
432.03.06	32-06 K	6	32	37	60
432.03.08	32-08 K	8	32	37	60
432.03.10	32-10 K	10	32	37	60
432.03.12	32-12 K	12	32	37	60
432.03.16	32-16 K	16	32	37	60
432.03.20	32-20 K	20	32	37	60
432.03.25	32-25 K	25	32	37	60

Sealed | Abgedichtet | Lastikli

Reduction Sleeve

Reduzierhülse

Redüksiyon

For VDI Holders

Für VDI-Aufnahmen

VDI Tutucular için Kater Redüksiyonu

For Coolant Feeder

Für Kühlmittelzuführung

Dıştan Soğ. Takımlar için

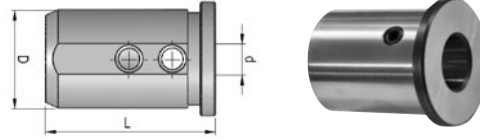
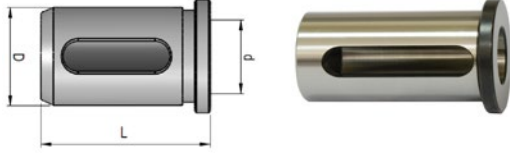

Order No. Bestell-Nr. Sipariş No.	Description Bezeichnung Açıklama	d	D	L
232.32.106	32-06 V	6	32	70
232.32.108	32-08 V	8	32	70
232.32.110	32-10 V	10	32	70
232.32.112	32-12 V	12	32	70
232.32.116	32-16 V	16	32	70
232.32.120	32-20 V	20	32	70
232.32.125	32-25 V	25	32	70
232.40.106	40-06 V	6	40	80
232.40.108	40-08 V	8	40	80
232.40.110	40-10 V	10	40	80
232.40.112	40-12 V	12	40	80
232.40.116	40-16 V	16	40	80
232.40.120	40-20 V	20	40	80
232.40.125	40-25 V	25	40	80
232.40.132	40-32 V	32	40	80

Order No. Bestell-Nr. Sipariş No.	Description Bezeichnung Açıklama	d	D	L
230.32.106	32-06 D	6	32	55
230.32.108	32-08 D	8	32	55
230.32.110	32-10 D	10	32	55
230.32.112	32-12 D	12	32	55
230.32.116	32-16 D	16	32	55
230.32.120	32-20 D	20	32	55
230.32.125	32-25 D	25	32	55
230.40.110	40-10 D	10	40	55
230.40.112	40-12 D	12	40	55
230.40.116	40-16 D	16	40	55
230.40.120	40-20 D	20	40	55
230.40.125	40-25 D	25	40	60
230.40.132	40-32 D	32	40	65