



High speed precision spindles

SCHEDA TECNICA

AF110 CU PL ISO40



MODELLO	TENSIONE [Volt]	FREQUENZA [Hz]	GIRI	POT. RESA [Kw]	ASSORB. [Amp]	Cos j	PESO [Kg]
AF110 14/4 CU ISO 40 aria compressa	380	200/400	6000/12000	4,2	9,5	0,86	34
ISO 40 liquido	380	200/400	6000/12000	5,0	11,4	0,86	34

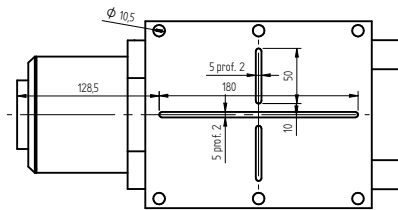
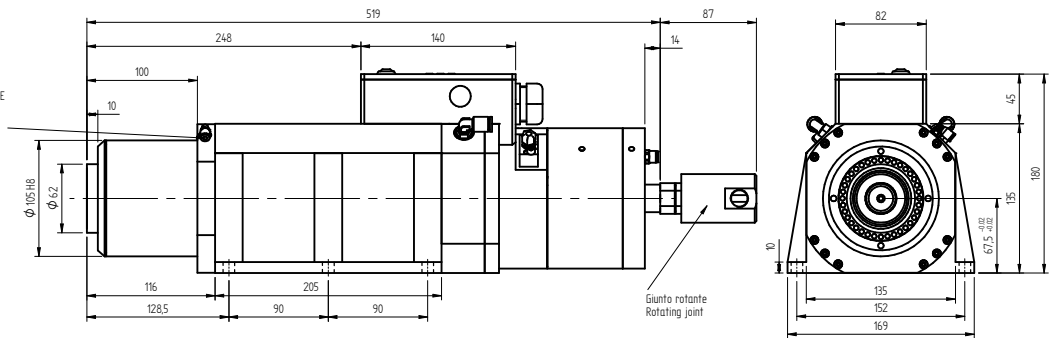
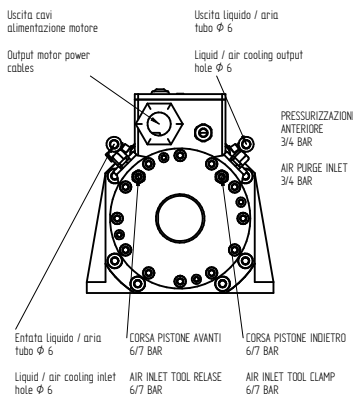

LE NOSTRE PROTEZIONI
OUR PROTECTIONS

Sensore S4 - Pistone indietro
S4 Sensor - Backward

Sensore S3 - Rotazione albero
S3 sensor - shaft rotation

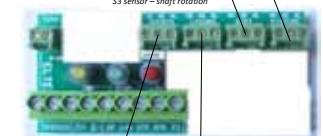

Sensore S1 - pinna aperta
S1 sensor - Collet open

Sensore S2 - Mandrino in posizione lavoro
S2 sensor - Spindle in work position

